

UTC RETAIL 2200- Integration Tray Installation Guide

The following components are included in the tray kit:

- 11393198 - TRAY PERIPHERAL COUNTERTOP
- 11393003 - BEZEL, Cover CBL PRINTER GRY
- 11393004 - BEZEL, COVER CBL LCD FRONT GRY
- 11393005 - BEZEL, COVER CBL LCD REAR GRY
- 11393005 - BEZEL, CABLE SLOT FILLER, QTY 3

Installation:

1. Open the Integration Tray box and remove the tray.
2. Remove all packing materials.
3. Mount the tray to the counter. Refer to diagram on the next page for recommended mounting details (NOTE: TRAY MUST BE MOUNTED TO THE COUNTER TO ENSURE STABILITY).

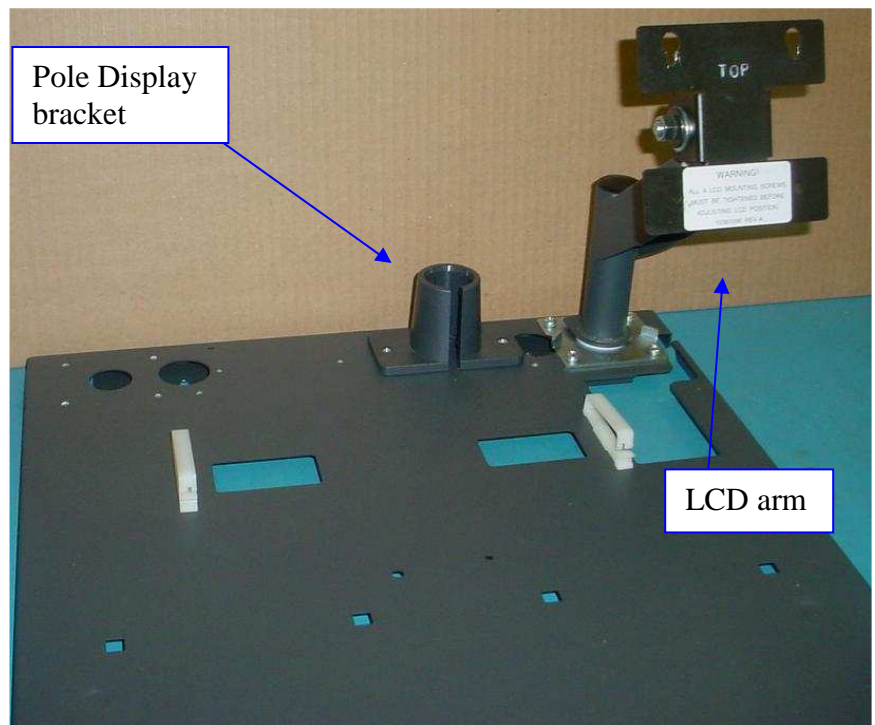

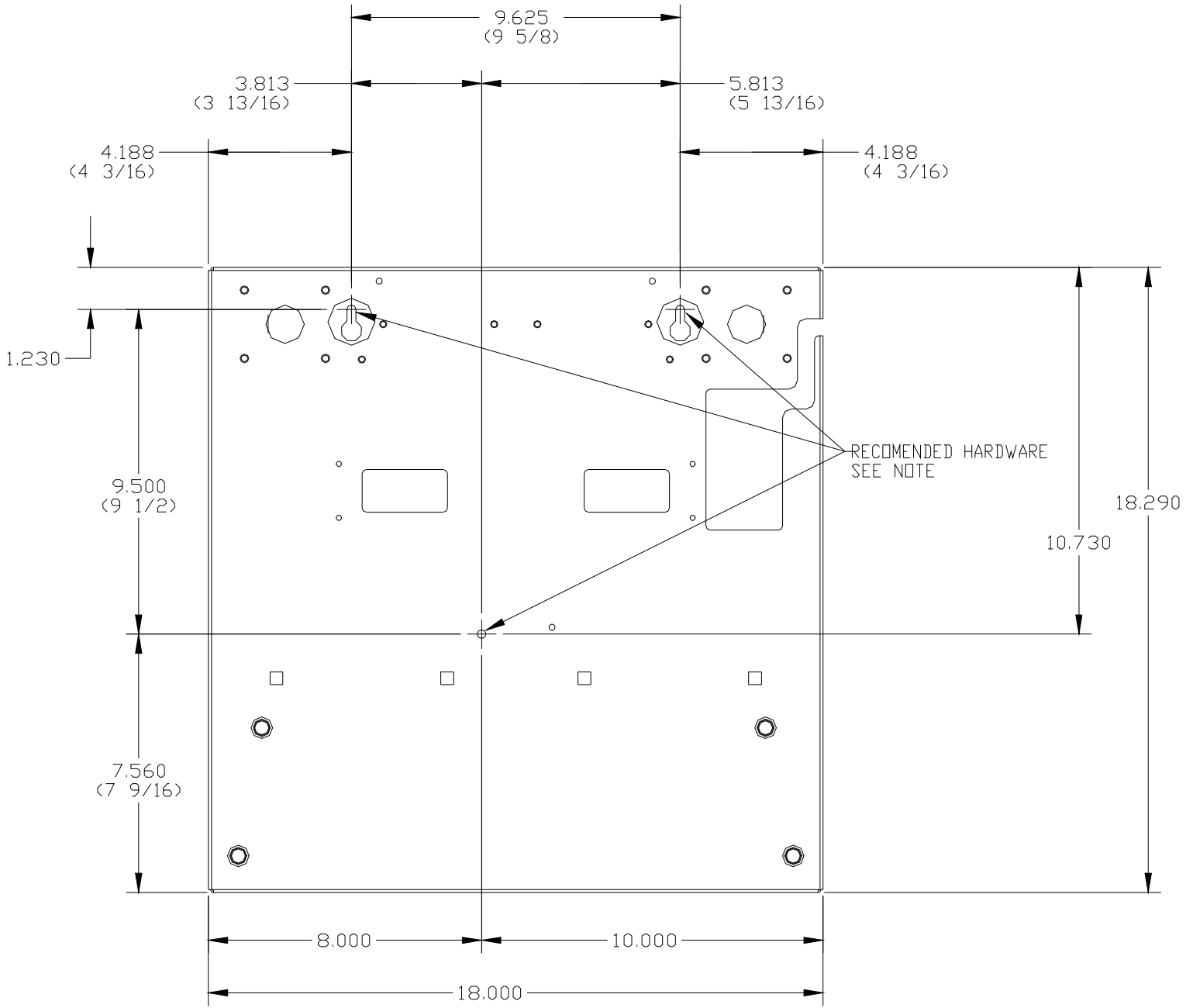

RECOMMENDED HARDWARE:

USE THREE 1/4-20 UNC SCREWS WITH WITH SPLIT AND FLAT WASHERS OR THREE 1/4 SELF TAPPING WOOD SCREWS.

Install the LCD Monitor

4. Open the LCD monitor box and remove the monitor.
5. Remove all packing materials.
6. Start 2 mounting screws into the top of the LCD monitor.
7. Take the LCD monitor and position the top 2 screws into the drop slots.
8. Start the other 2 mounting screws, and then tighten all 4 screws to securely fasten the LCD monitor to the mounting bracket.

WARNING! Make sure that the four mounting screws for the LCD monitor are SECURELY fastened, but do not over-tighten. Failure to do so will cause mechanical damage to the monitor.



9. Rotate the LCD monitor up so that the cable connection ports are visible.

Note: A 12" monitor with touch screen option is featured in these pictures. The 15" monitor has a different power connector. The female end plugs into the LCD.

10. Take the monitor power cable [1] out of the box and attach it to the LCD monitor.
11. Take the SVGA monitor data cable (DB15-pin cable) [2] out of the LCD Monitor box and attach it to the LCD monitor.
12. If applicable, take the touch screen interface cable (DB9-pin cable) [3] and attach it to the LCD monitor.



13. Gather the three cables together and route them through the LCD monitor arm cable channel.
14. Tie-wrap the cables to the monitor arm. (optional)
15. Route the cables into the cable access channel and through either:
 - a) hole in countertop under the tray, or
 - b) cutout on right hand side of tray (as shown in picture).
16. Rotate the monitor down to its operational position.



Install the UTC RETAIL PD1200 Pole Display

17. Open the pole display box and remove the pole display.
 18. Remove all packing materials.
 19. Take the pole assembly and insert it into the hat bracket.
 20. Route the pole display cable, the two keyboard cable(s), and printer cable(s) through the left-hand cable clamp, then
 21. Either route the three cables to the back of the unit (as shown in this picture), or route the three cables down to the hole in the counter under the tray.
-
22. Install the 3 plastic covers as shown being careful not to pinch any cables. Use slot fillers to plug unused openings.
 23. Installation is complete.

